



The Abergelli Power Gas Fired Generating Station Order

2.6 Indicative Site Layout Plan

Planning Act 2008
The Infrastructure Planning
(Applications: Prescribed Forms and Procedure) Regulations 2009

PINS Reference Number: EN010069
Document Reference: 2.6
Regulation Number: 5(2)(o)
Author: WSP

Revision	Date	Description
0	May 2018	Submission Version



CONTENTS

Figure 1	INDICATIVE LAYOUT Project Site Reg5(2)(o)
Figure 2	INDICATIVE LAYOUT Generating Equipment Reg5(2)(o)
Figure 3	INDICATIVE LAYOUT Access Road Reg5(2)(o)

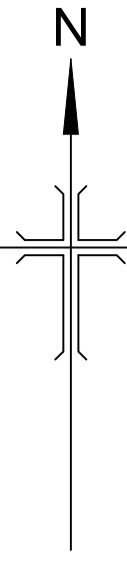

- LEGEND**
- ORDER LAND
 - ORDER LIMITS
 - ACCESS ROAD

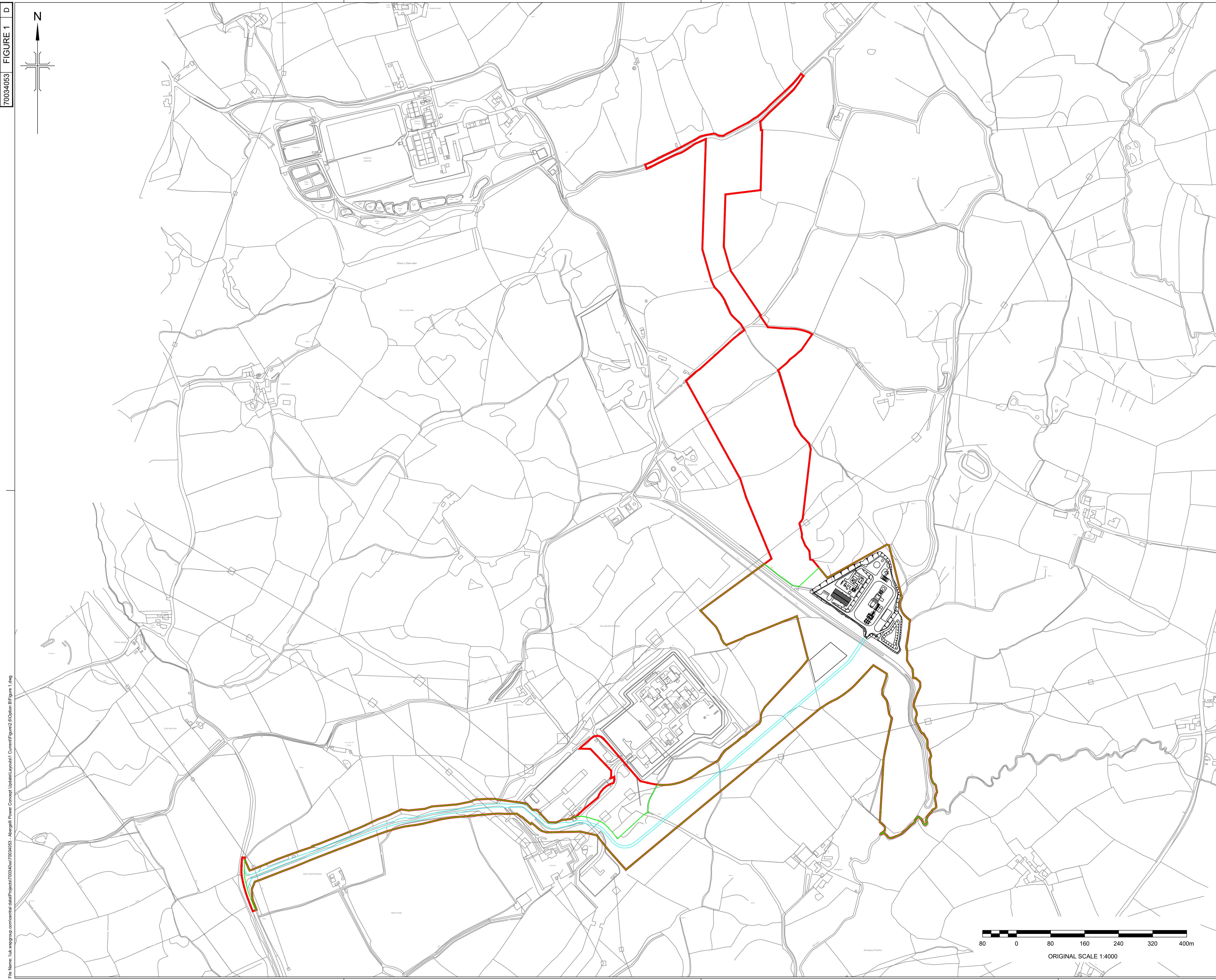

Rev	Date	Description	By	Chk	App
D	10/05/2018	UPDATED IN LINE WITH CLIENT COMMENTS	SPS	SJS	IMG
C	03/04/2018	LEGEND UPDATED	SPS	SJS	IMG
B	22/03/2018	ATTENUATION POND DETAILS UPDATED. WATER EASEMENT UPDATED	SPS	SJS	IMG
A	16/02/2018	FIRST ISSUE	JPW	SJS	IMG

INDICATIVE



Westbrook Mills
Godalming
Surrey GU7 2AZ

Tel: 44-(0)1483-528400
Fax: 44-(0)1483-528989
wsp.com



**ABERGELLI
POWER
PROJECT**

**INDICATIVE LAYOUT
Project Site Reg5(2)(o)
DOCUMENT REFERENCE 2.6**

Drawn: JPW	Checked: SJS
Designed: IMG	Approved: IMG
Date: 16/02/2018	Scale: 1:4000
Project Number: 70034053	Drawing Number: FIGURE 1
Sheet: 1 OF 1	Revision:

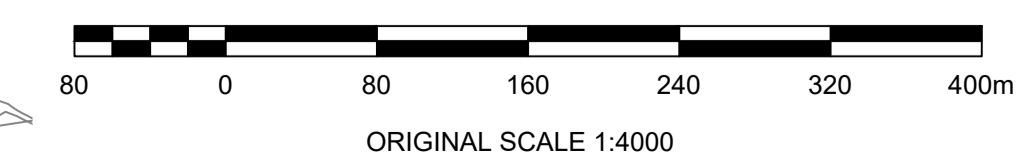

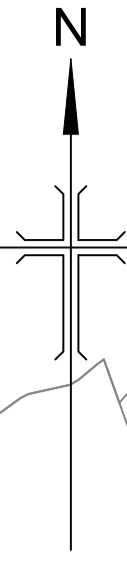

LEGEND

	ORDER LAND
	ORDER LIMITS
	ACCESS ROAD

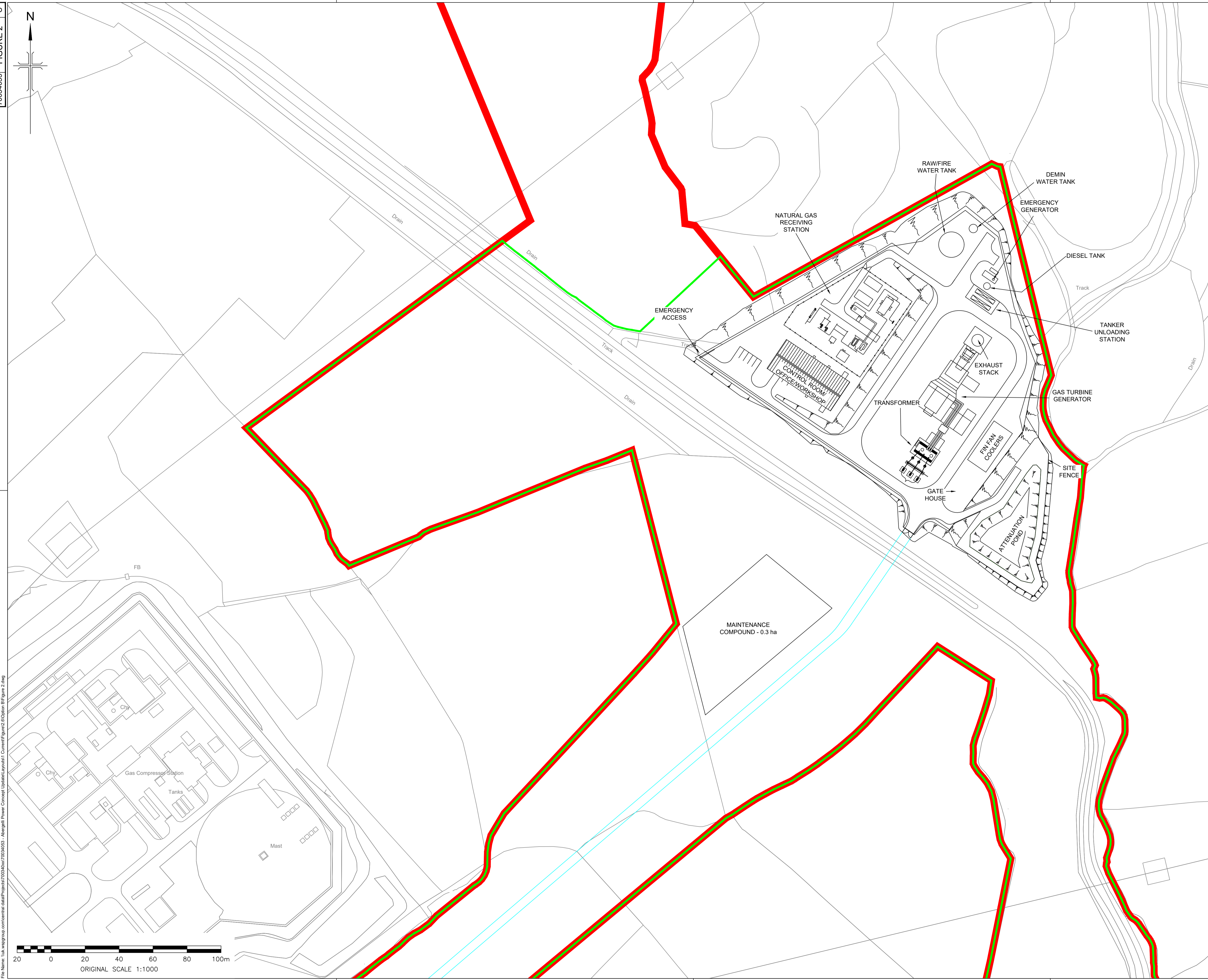

NOTES:
 * INFORMATION TAKEN FROM WEST GLAMORGAN WATER BOARD RECORD DRAWINGS No. 112/4/1/12A DATED 1969

Rev	Date	Description	By	Chk	App
C	10/05/2018	UPDATED IN LINE WITH CLIENT COMMENTS	SPS	SJS	IMG
B	03/04/2018	LEGEND UPDATED	SPS	SJS	IMG
A	16/02/2018	FIRST ISSUE	JPW	SJS	IMG

INDICATIVE

Westbrook Mills
Godalming
Surrey GU7 2AZ

Tel: 44-(0)1483-528400
Fax: 44-(0)1483-528989
wsp.com

Client:

Site/Project:

**ABERGELLI
POWER PROJECT**

Title:

**INDICATIVE LAYOUT
GENERATING EQUIPMENT
Reg5(2)(o)
DOCUMENT REFERENCE 2.6**

Drawn: JPW	Checked: SJS
Designed: IMG	Approved: IMG
Date: 16/02/2018	Scale: 1:1000
Project Number: 70034053	Drawing Number: FIGURE 2
Sheet: 1 OF 1	Revision:

© Copyright WSP UK Limited

File Name: \\uk.wspgroup.com\central_data\Project\70034053 - Abergelli Power Concept Update\LAYOUT\Current\Figure2.dwg

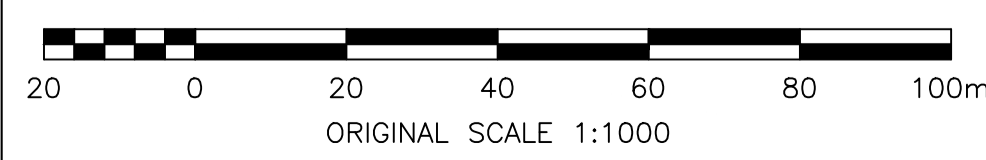

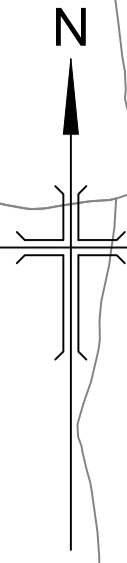

- LEGEND**
- ORDER LAND
 - ORDER LIMITS
 - ACCESS ROAD

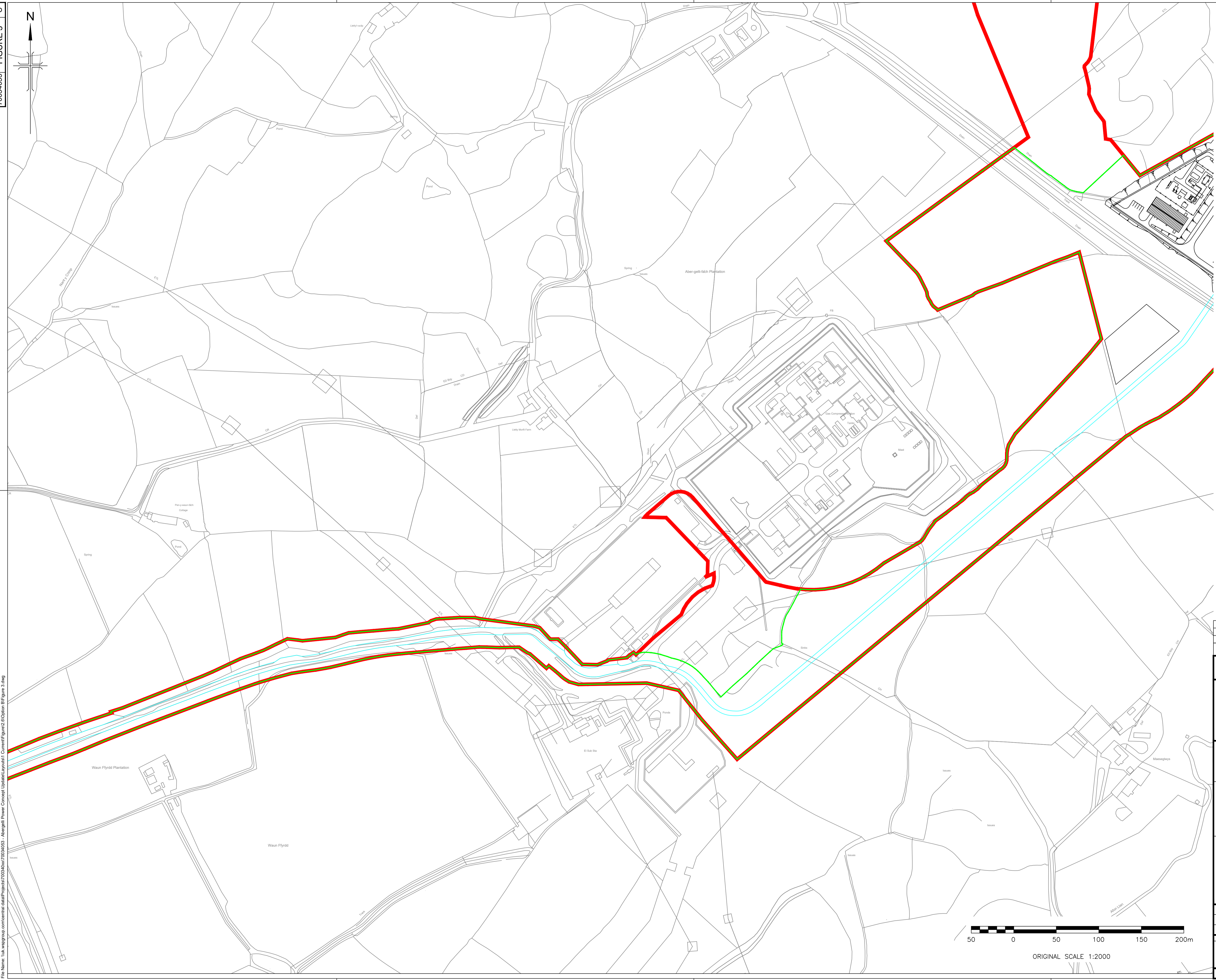

Rev	Date	Description	By	Chk	App
C	10/05/2018	UPDATED IN LINE WITH CLIENT COMMENTS	SPS	SJS	IMG
B	03/04/2018	LEGEND UPDATED	SPS	SJS	IMG
A	16/02/2018	FIRST ISSUE	JPW	SJS	IMG

INDICATIVE

Westbrook Mills
Godalming
Surrey GU7 2AZ

Tel: 44-(0)1483-528400
Fax: 44-(0)1483-528989
wsp.com

Client:

Abergelli power
A Dura Group company

Site/Project:

ABERGELLI POWER PROJECT

Title:

INDICATIVE LAYOUT
ACCESS ROAD
Reg5(2)(o)
DOCUMENT REFERENCE 2.6

Drawn: JPW	Checked: SJS
Designed: IMG	Approved: IMG
Date: 16/02/2018	Scale: 1:2000
Project Number: 70034053	Drawing Number: FIGURE 3
Sheet: 1 OF 1	Revision:

70034053 FIGURE 3 C

© Copyright WSP UK Limited

